

CUMHURBAŞKANI KARARI

**Karar Sayısı: 6046**

Bitlis İli, Ahlat İlçesi, Tunus Mahallesi sınırları içerisinde bulunan ve ekli harita ile listede sınır ve koordinatları gösterilen sahada yer alan özel mülkiyete konu taşınmazların, Toplu Konut İdaresi Başkanlığınca başlatılan konut projesi kapsamında ihtiyaç duyulan yapılaşmanın ivedilikle sağlanması amacıyla anılan Başkanlık tarafından acele kamulaştırılmasına, 2942 sayılı Kamulaştırma Kanununun 27 nci maddesi gereğince karar verilmiştir.

14 Eylül 2022

Recep Tayyip ERDOĞAN
CUMHURBAŞKANI

14/9/2022 TARİHLİ VE 6046 SAYILI CUMHURBAŞKANI KARARININ EKİ

KAMULAŞTIRMA HARİTASI

İLİ :BİTLİS

İLÇESİ :AHLAT

MAH/KÖY :TUNUS

----- Kamulaştırma Sınırı

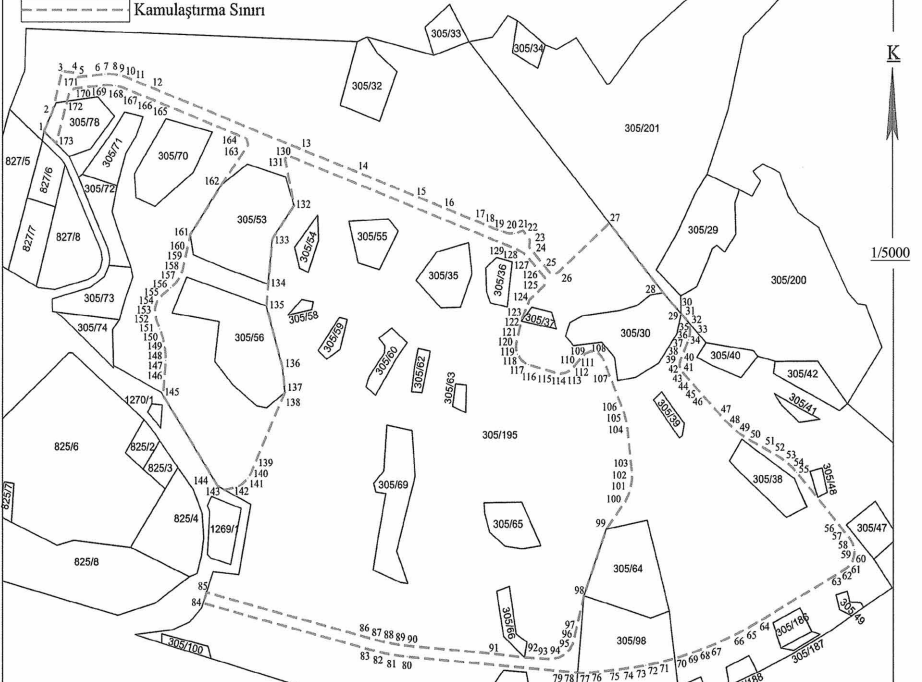

KAMULAŞTIRMA SINIRI
KÖŞE KOORDİNATLARI LİSTESİ
ITRF Dilim No: 42

N.No	Y	X	N.No	Y	X	N.No	Y	X	N.No	Y	X	N.No	Y	X
1	546130.73	4292221.35	39	546764.79	4292011.39	77	546671.14	4291726.74	115	546604.39	4292001.08	153	546240.84	4292054.84
2	546139.16	4292239.22	40	546764.53	4292009.96	78	546667.88	4291726.70	116	546613.46	4292008.52	154	546241.04	4292060.33
3	546148.86	4292276.20	41	546764.47	4292008.51	79	546662.38	4291726.99	117	546611.10	4292009.36	155	546242.91	4292065.71
4	546160.96	4292276.61	42	546764.62	4292007.06	80	546492.79	4291741.34	118	546606.88	4292012.04	156	546246.43	4292072.17
5	546164.66	4292270.73	43	546764.99	4292005.65	81	546484.00	4291742.27	119	546602.44	4292018.04	157	546256.86	4292078.64
6	546191.51	4292273.63	44	546765.55	4292004.31	82	546470.91	4291744.33	120	546601.12	4292022.85	158	546261.19	4292082.30
7	546196.39	4292273.65	45	546766.30	4292003.07	83	546457.97	4291747.21	121	546601.25	4292027.85	159	546264.78	4292086.87
8	546200.39	4292273.35	46	546767.22	4292001.94	84	546289.05	4291790.21	122	546601.86	4292030.28	160	546268.51	4292091.71
9	546205.35	4292272.43	47	546808.96	4291950.13	85	546292.51	4291800.09	123	546606.33	4292048.30	161	546276.19	4292127.23
10	546209.94	4292271.40	48	546822.69	4291946.44	86	546460.43	4291756.90	124	546614.35	4292067.73	162	546306.99	4292127.23
11	546213.52	4292270.19	49	546825.71	4291944.46	87	546464.53	4291755.90	125	546629.20	4292080.76	163	546334.22	4292209.06
12	546243.83	4292258.81	50	546831.97	4291940.87	88	546472.77	4291754.16	126	546629.53	4292087.82	164	546332.44	4292214.89
13	546289.13	4292204.30	51	546881.39	4291925.91	89	546485.26	4291752.19	127	546619.43	4292106.04	165	546210.00	4292262.83
14	546447.38	4292182.44	52	546864.12	4291924.11	90	546493.64	4291751.30	128	546608.46	4292110.45	166	546205.75	4292262.19
15	546507.78	4292159.72	53	546869.38	4291920.73	91	546577.71	4291744.19	129	546602.57	4292113.52	167	546201.98	4292263.02
16	546532.24	4292150.56	54	546876.55	4291914.78	92	546609.74	4291740.79	130	546374.28	4292169.18	168	546194.15	4292263.59
17	546557.59	4292137.32	55	546880.65	4291910.28	93	546633.74	4291739.45	131	546371.04	4292198.39	169	546189.22	4292263.42
18	546586.31	4292130.30	56	546933.75	4291849.35	94	546643.39	4291740.62	132	546380.22	4292153.86	170	546180.64	4292262.22
19	546593.51	4292128.37	57	546936.57	4291844.91	95	546649.20	4291743.54	133	546358.84	4292127.48	171	546156.03	4292258.24
20	546599.47	4292128.39	58	546937.98	4291839.84	96	546654.01	4291747.92	134	546354.55	4292081.74	172	546153.90	4292258.24
21	546602.40	4292128.93	59	546937.95	4291834.58	97	546657.45	4291753.44	135	546352.71	4292106.89	173	546143.02	4292210.19
22	546607.97	4292131.04	60	546936.19	4291829.59	98	546668.62	4291797.37	136	546368.83	4292004.80			
23	546614.72	4292122.71	61	546933.14	4291825.30	99	546669.80	4291858.30	137	546371.11	4291982.90			
24	546614.28	4292115.65	62	546931.19	4291823.53	100	546710.01	4291863.41	138	546367.53	4291975.56			
25	546646.78	4292092.45	63	546928.98	4291822.38	101	546714.71	4291863.41	139	546337.28	4291909.69			
26	546641.83	4292092.02	64	546841.99	4291773.46	102	546716.75	4291803.55	140	546334.10	4291904.59			
27	546693.92	4292138.03	65	546831.54	4291767.85	103	546718.58	4291810.70	141	546327.50	4291898.65			
28	546747.81	4292074.34	66	546820.90	4291762.58	104	546711.98	4291850.71	142	546322.07	4291866.15			
29	546765.84	4292065.57	67	546789.12	4291753.14	105	546710.92	4291857.44	143	546310.66	4291893.71			
30	546772.15	4292046.69	68	546776.76	4291745.17	106	546708.13	4291866.22	144	546303.64	4291897.22			
31	546772.79	4292047.54	69	546765.39	4291741.75	107	546687.57	4292013.77	145	546249.13	4291880.19			
32	546773.81	4292044.92	70	546759.72	4291740.25	108	546693.62	4292018.66	146	546237.45	4291865.54			
33	546774.46	4292042.18	71	546753.92	4291738.72	109	546714.01	4292020.85	147	546231.88	4291865.78			
34	546774.71	4292039.38	72	546742.35	4291736.07	110	546669.71	4292018.62	148	546215.64	4292016.13			
35	546774.56	4292038.56	73	546730.70	4291733.81	111	546657.25	4292005.77	149	546205.78	4292024.57			
36	546774.03	4292033.80	74	546718.97	4291731.94	112	546653.68	4292002.90	150	546246.87	4292032.85			
37	546773.11	4292031.14	75	546707.20	4291720.46	113	546649.49	4292001.09	151	546245.96	4292040.82			
38	546765.27	4292012.77	76	546676.02	4291727.09	114	546644.93	4292000.46	152	546242.32	4292049.14			